

RESOLUTION NO. 3917

A RESOLUTION SETTING IN-LIEU-OF ASSESSMENT CHARGES FOR A PORTION OF THE COLUMBUS STREET SANITARY SEWER LIFT STATION PROJECT COSTS, WHICH WILL BE ALLOCATED TO UNASSESSED PROPERTIES WITHIN THE LIFT STATION SERVICE AREA.

WHEREAS, the Council of the City of Albany has authorized the expenditure of up to \$243,000 in oversizing participation be paid to the Mennonite Home of Albany, Inc., from the Sewer Economic Development Budget (02-952) for construction of the Columbus Street lift station, which is designed to provide service to approximately 316 acres of land within the designated City of Albany Urban Growth Boundary, in addition to approximately 40 acres of the Mennonite Home property; and

WHEREAS, the lift station service area as shown in Exhibit "A" does not include the portions of several properties within the lift station service area which the City of Albany Comprehensive Plan designates as Open Space (OS); and

WHEREAS, the Council desires to recover the expenditure of these oversizing costs through the implementation of a special in-lieu-of assessment (ILA) to be levied on the unassessed properties within the lift station service area as shown on the map in Exhibit "A;" and

WHEREAS, the ILA rate for each property within the lift station service area shall be based on the ratio of the area of each property to the total benefited area applied to the total non-assessed City contribution; and

WHEREAS, this special ILA shall apply to unassessed properties within the lift station service area, and is considered to be in addition to other sanitary sewer ILA's that may otherwise be levied; and

WHEREAS, the ILA amounts contained herein are based on an engineering project estimate, and following completion of the lift station and acceptance by the City, the ILA amounts shall be adjusted by Resolution and shall be based on the actual project costs and the actual total non-assessed City contribution; and

WHEREAS, the adjusted ILA charges established in the Resolution following completion of the lift station construction shall be automatically adjusted on the first day of July each calendar year thereafter in proportion to the change in the Seattle Construction Cost Index as published in the June edition of Engineering News Record (ENR).

NOW, THEREFORE, BE IT RESOLVED that the Columbus Street Lift Station In-Lieu-of Assessment Benefited Area is hereby established and adopted as shown in the map in Exhibit "A" attached hereto, and the in-lieu-of assessment rates for each property within the benefited area are hereby established and adopted as listed in Exhibit "B" attached hereto; and

BE IT FURTHER RESOLVED that the ILA rates as listed in Exhibit "B" are based on engineering project estimates, and following completion of the lift station, and acceptance by the City, the ILA amounts shall be adjusted by Resolution, and shall be based on the actual project costs and the actual total non-assessed City contribution; and

BE IT FURTHER RESOLVED that this special ILA shall apply to unassessed properties within the lift station service area and is considered to be in addition to other sanitary sewer ILA's that may otherwise be levied; and

BE IT FURTHER RESOLVED that ILA payments received under this Resolution shall be directed to the Sewer Economic Development Budget (02-952) in order to compensate for the initial expenditure from that fund for the lift station oversizing costs; and

BE IT FURTHER RESOLVED that the adjusted ILA charges established in the Resolution following completion of the lift station construction shall be automatically adjusted on the first day of July each calendar year thereafter in proportion to the change in the Seattle Construction Cost Index as published in the June edition of Engineering News Record (ENR). The adjustment shall be made by calculating the percentage increase/decrease in the index from the last adjustment, and then applying that percentage to the previous year's ILA fees. The Resolution adjusting the ILA rates for the actual project costs shall contain the ENR index number in effect at that time.

DATED THIS 11TH DAY OF MARCH 1998.



Mayor

ATTEST:



City Recorder

EXHIBIT "A"

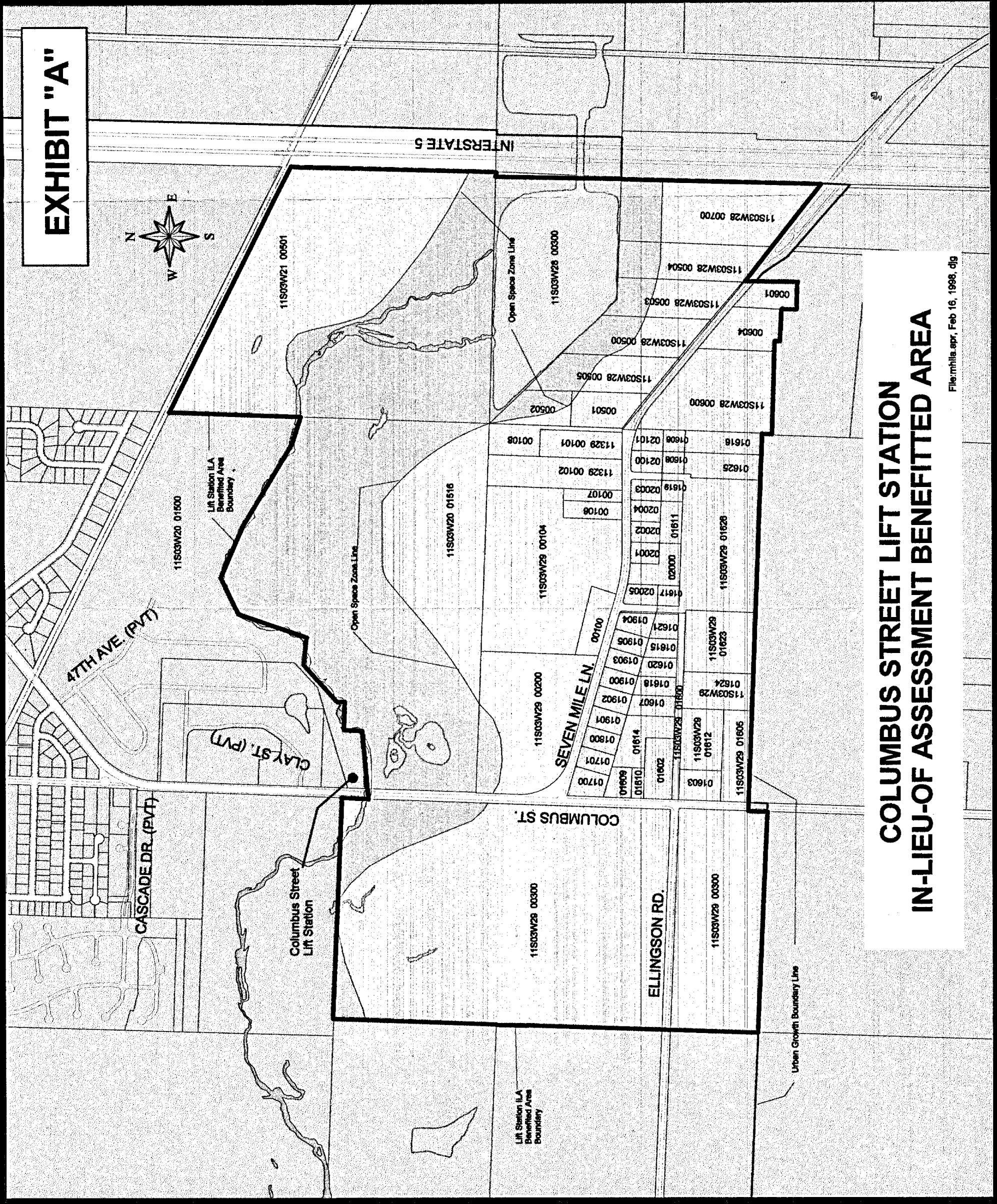
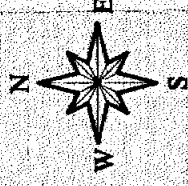

**COLUMBUS STREET LIFT STATION
IN-LIEU-OF ASSESSMENT BENEFITTED AREA**

EXHIBIT "B"

| Columbus Street Lift Station: In - Lieu - of Assessment Allocation (Area Basis) | | | | | |
|---------------------------------------------------------------------------------|-----------|----------------|--------------|------------|-------------------|
| | | Tax Lot Number | Area Sq Ft | Area Acres | ILA Apportionment |
| Total Project Cost | \$270,000 | 11S03W21 00501 | 1815229.746 | 41.67 | \$32,086 |
| | | 11S03W20 01516 | 997225.457 | 22.89 | \$17,627 |
| Less Mennonite Home | \$27,000 | 11S03W28 00500 | 124230.827 | 2.85 | \$2,196 |
| Contribution (10%) | | 11S03W28 00501 | 113713.589 | 2.61 | \$2,010 |
| | | 11S03W28 00502 | 37171.585 | 0.85 | \$657 |
| Total Oversizing | \$243,000 | 11S03W28 00503 | 146298.683 | 3.36 | \$2,586 |
| | | 11S03W28 00504 | 180050.738 | 4.13 | \$3,183 |
| Benefited Area, Acres | 315.60 | 11S03W28 00505 | 136071.310 | 3.12 | \$2,405 |
| | | 11S03W28 00600 | 449423.502 | 10.32 | \$7,944 |
| In-Lieu-of \$ per Acre | \$770 | 11S03W28 00601 | 72620.631 | 1.67 | \$1,284 |
| | | 11S03W28 00604 | 139578.819 | 3.20 | \$2,467 |
| | | 11S03W28 00700 | 442946.410 | 10.17 | \$7,830 |
| | | 11S03W29 00100 | 82956.775 | 1.90 | \$1,466 |
| | | 11S03W29 00101 | 112908.855 | 2.59 | \$1,996 |
| | | 11S03W29 00102 | 210942.359 | 4.84 | \$3,729 |
| | | 11S03W29 00104 | 941521.340 | 21.61 | \$16,642 |
| | | 11S03W29 00106 | 51014.203 | 1.17 | \$902 |
| | | 11S03W29 00107 | 35840.923 | 0.82 | \$634 |
| | | 11S03W29 00108 | 97699.330 | 2.24 | \$1,727 |
| | | 11S03W29 00200 | 613591.787 | 14.09 | \$10,846 |
| | | 11S03W29 00300 | 4282476.948 | 98.31 | \$75,697 |
| | | 11S03W29 01600 | 66763.792 | 1.53 | \$1,180 |
| | | 11S03W29 01602 | 87056.308 | 2.00 | \$1,539 |
| | | 11S03W29 01603 | 64608.089 | 1.48 | \$1,142 |
| | | 11S03W29 01605 | 130413.640 | 2.99 | \$2,305 |
| | | 11S03W29 01606 | 23945.177 | 0.55 | \$423 |
| | | 11S03W29 01607 | 46885.434 | 1.08 | \$829 |
| | | 11S03W29 01608 | 23761.415 | 0.55 | \$420 |
| | | 11S03W29 01609 | 37159.615 | 0.85 | \$657 |
| | | 11S03W29 01610 | 19129.101 | 0.44 | \$338 |
| | | 11S03W29 01611 | 46177.128 | 1.06 | \$816 |
| | | 11S03W29 01612 | 129169.574 | 2.97 | \$2,283 |
| | | 11S03W29 01614 | 100217.654 | 2.30 | \$1,771 |
| | | 11S03W29 01615 | 29946.897 | 0.69 | \$529 |
| | | 11S03W29 01616 | 84755.426 | 1.95 | \$1,498 |
| | | 11S03W29 01617 | 22250.243 | 0.51 | \$393 |
| | | 11S03W29 01618 | 39046.378 | 0.90 | \$690 |
| | | 11S03W29 01619 | 23119.279 | 0.53 | \$409 |
| | | 11S03W29 01620 | 34496.638 | 0.79 | \$610 |
| | | 11S03W29 01621 | 32277.363 | 0.74 | \$571 |
| | | 11S03W29 01623 | 217207.078 | 4.99 | \$3,839 |
| | | 11S03W29 01624 | 130346.897 | 2.99 | \$2,304 |
| | | 11S03W29 01625 | 96603.904 | 2.22 | \$1,708 |
| | | 11S03W29 01626 | 535633.790 | 12.30 | \$9,468 |
| | | 11S03W29 01700 | 47230.250 | 1.08 | \$835 |
| | | 11S03W29 01701 | 37469.972 | 0.86 | \$662 |
| | | 11S03W29 01800 | 37458.947 | 0.86 | \$662 |
| | | 11S03W29 01900 | 34944.218 | 0.80 | \$618 |
| | | 11S03W29 01901 | 37452.639 | 0.86 | \$662 |
| | | 11S03W29 01902 | 37446.331 | 0.86 | \$662 |
| | | 11S03W29 01903 | 34938.723 | 0.80 | \$618 |
| | | 11S03W29 01904 | 37803.144 | 0.87 | \$668 |
| | | 11S03W29 01905 | 34933.228 | 0.80 | \$617 |
| | | 11S03W29 02000 | 77295.617 | 1.77 | \$1,366 |
| | | 11S03W29 02001 | 30341.944 | 0.70 | \$536 |
| | | 11S03W29 02002 | 31038.806 | 0.71 | \$549 |
| | | 11S03W29 02003 | 32506.844 | 0.75 | \$575 |
| | | 11S03W29 02004 | 31819.496 | 0.73 | \$562 |
| | | 11S03W29 02005 | 33514.342 | 0.77 | \$592 |
| | | 11S03W29 02100 | 34311.683 | 0.79 | \$606 |
| | | 11S03W29 02101 | 32387.842 | 0.74 | \$572 |
| Totals | | | 13747378.663 | 315.60 | \$243,000 |